

Lands Branch  
Titles Office

In Reply Please Quote  
File Reference No.

August 12, 2014

1030501

W. J. THORNE SURVEYS LTD.  
PO BOX 61  
BLAKETOWN NL A0B 1C0

### SURVEY AUTHORIZATION

You are hereby authorized to survey, at the expense of the applicant, the land as defined as follows:

Application No.	137984
Name of Applicant:	MUNN POULTRY FARM LIMITED
Location of land applied for:	near Hodgewater Pond and Triangular Pond
Land bounded on the North by:	SEE MAP
Land bounded on the South by:	SEE MAP
Land bounded on the East by:	SEE MAP
Land bounded on the West by:	SEE MAP
Area approved (in hectares):	126.568
Frontage approved (in metres):	0
Approved location indicated on the attached plan number:	01n06-571
Parcel identification number:	10101011

Please be advised that the dimensions of the approved site cannot be altered or relocated in any way without the prior approval of the Department as outlined in subsections 3.(2)(b) and 3.(2)(c) of the *Crown Land Survey Standards - 2009*.

Satisfactory survey returns must be submitted to this Department on or before otherwise the application will be deemed cancelled in accordance with Section 10 of *Lands Act*. Survey returns shall be in compliance with Section 10 of the *Crown Land Survey Standards - 2009*.

  
AUTHORIZED OFFICIAL

#### SPECIAL INSTRUCTIONS:

SURVEYOR TO ENSURE THAT THE AREA SURVEYED DOES NOT INCLUDE THE  
ADJACENT WATER SHED5 ha site 2 -> 37.5 ha site 3 -> 30 ha

See map portion in red to be excluded from survey

## SURVEYOR'S REPORT

APPLICANT: MUNN POULTRY FARM LIMITED

APPLICATION NO.: 137984

FILE NO.: 1030501

1. Did you find any evidence of an adverse claim to the land either valid or otherwise?  
Yes \_\_\_\_\_ No ☒

If yes, please include a typed report in compliance with Section 11 of the *Lands Act*:

2. List names of individuals, who provided information on the land status:

Curtis Somerset Peter Hearn  
\_\_\_\_\_  
\_\_\_\_\_

3. Were there any inconsistencies between the research documentation and the found field evidence?

Yes \_\_\_\_\_ No ☒

If yes, please include a typed report explaining procedures used to resolve these inconsistencies.

4. Have you found any verbal, documentary or physical evidence that may jeopardize the Crown in issuing a lease/grant/easement? Yes \_\_\_\_\_ No ☒  
If yes, please include a typed report.

5. Have you included an additional plan showing any evidence of occupation?

Yes \_\_\_\_\_ No ☒

6. Are all the boundary lines through wooded areas connecting the corners open and clear?

Yes ☒ No \_\_\_\_\_

If no, a typed report must be included explaining why not.

Surveyor's Stamp

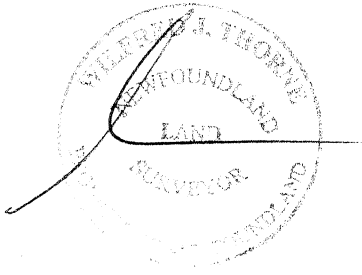

I hereby certify that these survey returns are in compliance with the *Crown Land Survey Standards - 2009* and that the survey plans and description submitted accurately represent the results of the survey performed by me on Aug 13/14.

NEWFOUNDLAND LAND SURVEYOR

# Munn Application Area

## Map 2: Forage Suitability Areas

NTS Reference IN6

Arena & Soil Interpretation completed by Rick St. Croix, Soil Specialists

Department of Natural Resources  
Land Resource Stewardship Division  
Soils and Mapping Services  
May 28, 2012

North American 1983 Datum Zone 22N  
Transverse Mercator

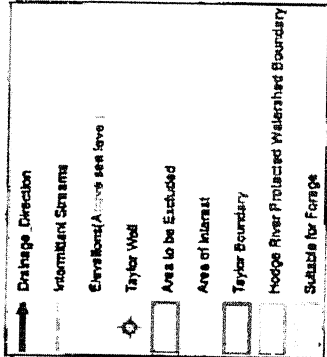

NOTE: 30% of polygons will be A3 due to steep side slopes, wet areas, low areas next to agriculture, and high boulder content in low lying areas. Estimated area suitable for forage is 10.1 Ha or 25.9 Ac.

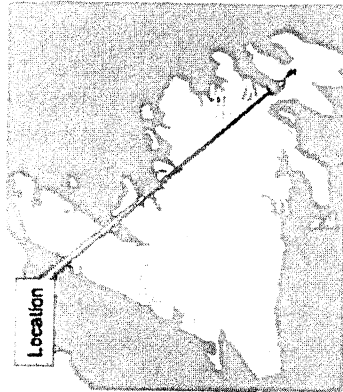

1:5,000

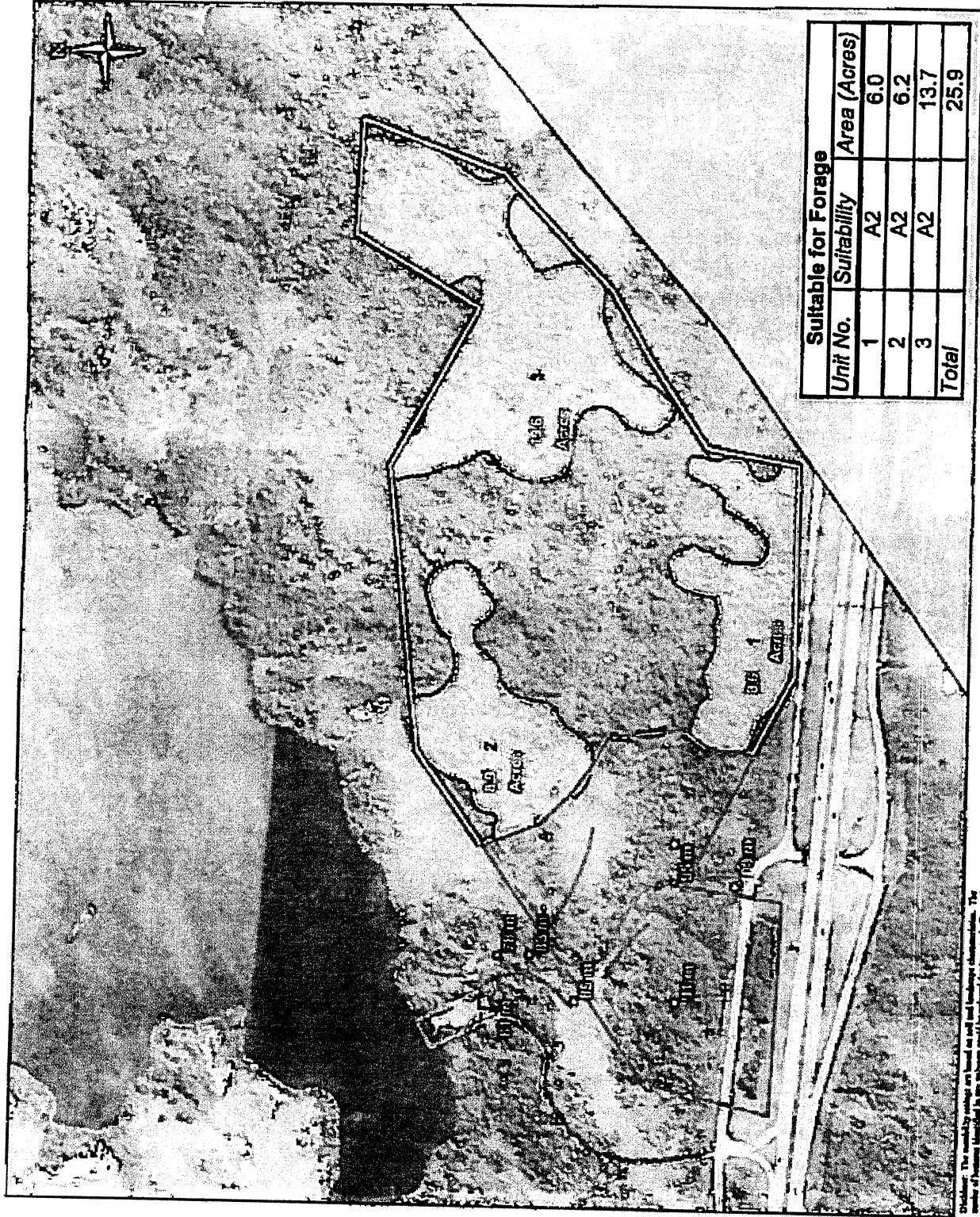

Suitable for Forage		
Unit No.	Suitability	Area (Acres)
1	A2	6.0
2	A2	6.2
3	A2	13.7
Total		25.9

Disclaimer: The suitability ratings are based on soil and landscape characteristics. The map shows the results of a field assessment and is not intended to be used for legal purposes. The map is for informational purposes only. The map is not a warranty of any kind. The map is not a guarantee of any kind. The map is not a representation of any kind. The map is not a statement of any kind. The map is not a declaration of any kind. The map is not a promise of any kind. The map is not a contract of any kind. The map is not a binding agreement of any kind. The map is not a legal document of any kind. The map is not a record of any kind. The map is not a source of any kind. The map is not a reference of any kind. The map is not a guide of any kind. The map is not a tool of any kind. The map is not a device of any kind. The map is not a system of any kind. The map is not a method of any kind. The map is not a process of any kind. The map is not a technique of any kind. The map is not a technology of any kind. The map is not a science of any kind. The map is not an art of any kind. The map is not a craft of any kind. The map is not a skill of any kind. The map is not a talent of any kind. The map is not a gift of any kind. The map is not a favor of any kind. The map is not a kindness of any kind. The map is not a mercy of any kind. The map is not a grace of any kind. The map is not a favor of any kind. The map is not a kindness of any kind. The map is not a mercy of any kind. The map is not a grace of any kind.

M:\STJH\GIS\LRIS\Shawn Howlett\Munn Farm\mun\_farm\_revision.mxd

SCHEDULE "A"

**All that** piece or parcel of land situate and being on the northern side of the Trans Canada Highway near Hodgewater Pond and Triangular Pond, abutted and bounded as follows, **that is to say:**

Beginning at a point, said point being a capped iron bar set at the southwestern corner of the land, and having grid co-ordinates of North 5,256,627.439 meters and East 273,145.896 meters;

Thence running along Crown Land, North sixty three degrees thirty seven minutes zero five seconds West (N 63° 37' 05" W), a distance of eighty seven decimal eight eight one meters (87.881m.) to a capped iron bar;

Thence North one degree forty two minutes fifty nine seconds East (N 1° 42' 59" E), a distance of fifty eight decimal eight eight two two meters (58.822m.) to a capped iron bar;

Thence North thirty four degrees twenty eight minutes nineteen seconds East (N 34° 28' 19" E), a distance of thirty four decimal four two seven meters (34.427 m.) to a capped iron bar;

Thence North nine degrees forty five minutes twenty four seconds West (N 9° 45' 24" W), a distance of ninety one decimal three nine three meters (91.393 m.) to a capped iron bar;

Thence North sixty seven degrees zero seven minutes thirteen seconds West (N 67° 07' 13" W), a distance of seventy three decimal five zero three meters (73.503 m.) to a capped iron bar;

Thence North forty three degrees zero five minutes zero six seconds West (N 43° 05' 06" W), a distance of seventy decimal zero six five meters (70.065 m.) to a capped iron bar;

Thence North twenty four degrees forty eight minutes fifty seconds West (N 24° 48' 50" W), a distance of ninety five decimal three one nine meters (95.319 m.) to a capped iron bar;

Thence North fifty four degrees fifty seven minutes zero two seconds East (N 54° 57' 02" E), a distance of one hundred fifty nine decimal nine zero zero meters (159.900 m.) to a capped iron bar;

Thence North eighty two degrees forty five minutes twenty two seconds East (N 82° 45' 22" E), a distance of four hundred eight decimal two one three meters (408.213m.) to a capped iron bar;

Thence South sixty five degrees fourteen minutes thirty two seconds East (S 65° 14' 32" E), a distance of two hundred twenty one decimal eight four one meters (221.841m.) to a capped iron bar;

Thence North twenty six degrees thirty four minutes fifteen seconds East (N 26° 34' 15" E), a distance of one hundred thirty nine decimal eight seven three meters (139.873m.) to a capped iron bar;

Thence South eighty degrees fifty minutes twenty seconds East (S 80° 50' 20" E), a distance of eighty two decimal two five five meters (82.255m.) to a capped iron bar;

Thence South five degrees forty four minutes twenty seconds West (S 5° 44' 20" W), a distance of one hundred forty five decimal zero four six meters (145.046m.) to a capped iron bar;

Thence South forty six degrees forty six minutes thirty three seconds West (S 46° 46' 33"W), a distance of one hundred sixty one decimal zero zero eight meters (161.008m.) to a capped iron bar;

Thence South ten degrees forty two minutes fifty three seconds East (S 10° 42' 53"E), a distance of sixty nine decimal two eight eight meters (69.288m.) to a capped iron bar;

Thence North forty six degrees thirty nine minutes eighteen second East (N 46° 39' 18" E), a distance of one hundred seventy decimal four six five meters (170.465m.) to a capped iron bar;

Thence South thirty eight degrees fifty seven minutes thirty six seconds East (S 38° 57' 36"E), a distance of fifty five decimal eight nine nine meters (55.899m.) to a capped iron bar;

Thence South forty seven degrees thirteen minutes forty four seconds West (S 47° 13' 44" W), a distance of three hundred seven decimal nine six three meters (307.963m.) to a capped iron bar;

Thence North twenty six degrees ten minutes thirty eight seconds East (N 26° 10' 38" E), a distance of sixty eight decimal three one three meters (68.313m.) to a capped iron bar;

Thence North forty one degrees twelve minutes forty seven seconds West (N 41° 12' 47" W), a distance of ninety eight decimal six eight one meters (98.681m.) to a capped iron bar;

Thence South fifty five degrees twenty seven minutes zero three seconds West (S 55° 27' 03" W), a distance of one hundred seventy decimal three nine eight meters (170.398m.) to a capped iron bar;

Thence South six degrees zero zero minutes thirteen seconds West (S 6° 00' 13" W), a distance of one hundred thirty five decimal two seven nine meters (135.279m.) to a capped iron bar;

Thence running along the northern limit of a Service Road, twenty (20) meters wide, North eighty eight degrees zero nine minutes twenty six seconds West (N 88° 09' 26" W), a distance of two hundred seventy seven decimal four zero zero meters (277.400m.), more or less, to the point of beginning;

Containing an area of thirty one decimal three one one (31.311) hectares, more or less, and being more particularly described and delineated on the drawing annexed hereto.

All bearings are referred to the meridian of fifty three degrees West longitude of the Modified Three Degree Transverse Mercator Projection for Newfoundland with NAD83, Zone 1 reference datum.

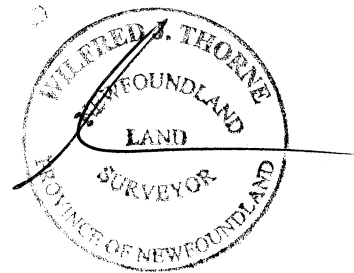

***W.J. Thorne Surveys Limited***  
***August 13, 2014***

**Appl. No 137984**

Schedule "B"

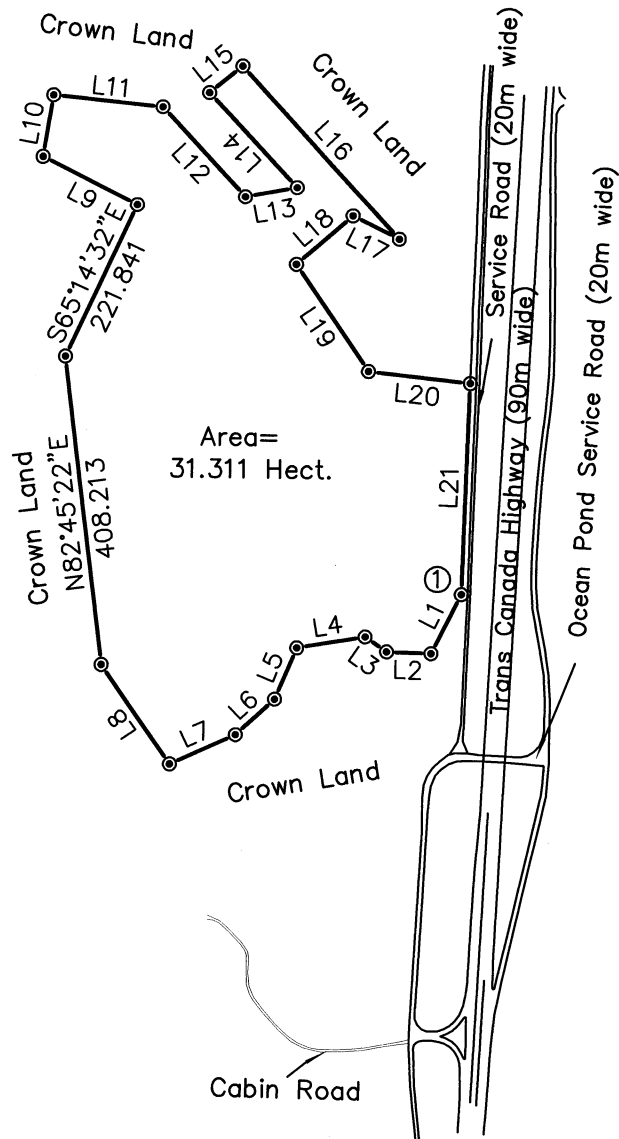
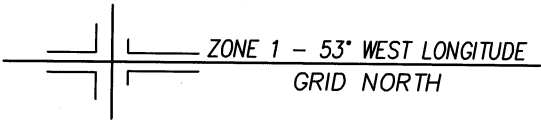

LEGEND

- FIB Found Iron Bar
- ⊙ Capped Iron Bar
- Iron Bar
- ⊛ Power Pole
- Power Line
- x- Fence Line

NUM	BEARING	DISTANCE
L1	N63°37'05"W	87.881
L2	N1°42'59"E	58.822
L3	N34°28'19"E	34.427
L4	N9°45'24"W	91.393
L5	N67°07'13"W	73.503
L6	N43°05'06"W	70.065
L7	N24°48'50"W	95.319
L8	N54°57'02"E	159.900
L9	N26°34'15"E	139.873
L10	S80°50'20"E	82.255
L11	S5°44'20"W	145.046

NUM	BEARING	DISTANCE
L12	S46°46'33"W	161.008
L13	S10°42'53"E	69.288
L14	N46°39'18"E	170.465
L15	S38°57'36"E	55.899
L16	S47°13'44"W	307.963
L17	N26°10'38"E	68.313
L18	N41°12'47"W	98.681
L19	S55°27'03"W	170.398
L20	S6°00'13"W	135.279
L21	N88°09'26"W	277.400

Linear Measurement Horizontal Ground Distances.  
All Boundary Lines Cut or Open.  
NAD 83 Reference Datum.  
Co-ordinates derived by RTK GPS.  
Control Monument 82357 and 82423 used  
in Control Tie.

① N5,256,627.439  
E 273,145.896

