



c/o Kirk and Ann Marie Hodder

Owners and Operators

**Environment Assessment**

**File Ref No. 200.20.2027**

**Date: July 30, 2012**

1. **Name of Undertaking:**

Brown's Arm Quarry – Kirk and Ann Marie Hodder – Hubert Porter Land

Location: Porterville – Brown's Arm

2. **Name of Proponent:**

- I. **Name of Corporate Body:** A & B Construction Ltd.
- II. **Address:** P.O. Box 160, 13 Stanhope Rd, Lewisporte, NL, A0G 3A0
- III. **CEO:**
  - i. **Name:** Ann Marie Hodder
  - ii. **Official title:** Owner
  - iii. **Address:** P.O. Box 160, 13 Stanhope Rd, Lewisporte
  - iv. **Contact information:** (ph) 709-535-8691 ext:248, (h)709-535-0535, (c) 709-541-0660, (e-mail) [amhodder@notredameagencies.ca](mailto:amhodder@notredameagencies.ca)
- IV. **Principle Contact Person for Purposed of Environmental Assessment:**
  - i. **Name:** Ann Marie Hodder
  - ii. **Official title:** Owner
  - iii. **Address:** P.O. Box 160, 13 Stanhope Rd, Lewisporte
  - iv. **Contact information:** (ph) 709-535-8691 ext:248, (h)709-535-0535, (c) 709-541-0660, (e-mail) [amhodder@notredameagencies.ca](mailto:amhodder@notredameagencies.ca)

3. **The Undertaking:**

- I. **Nature of the undertaking:** Aggregate Quarry (Sand and Gravel)
- II. **Purpose of Undertaking:** To supply sand, gravel and aggregate to surrounding communities in the Lewisporte catchment area.

4. **Description of the Undertaking:**

- I. **Location:** Proposed pit is adjacent to a pit already in use by A & B Construction with a permit held by Kirk & Ann Marie Hodder (permit # 125505) formerly used by Adam's Construction Ltd. These pits are located in Porterville approximately 200 meters from the nearest roadway.
- II. **Pit Access:** The access to this proposed pit would be through the adjacent quarry – permit # 125505
- III. **Coordinates:** The UTM coordinates for this undertaking is: 632350E, 5457050N
- IV. **Attached Maps:**
  - i. **Sketch of proposed undertaking (Hubert Porters Land) in relation to existing quarries**
  - ii. **Google Earth map of the undertaking**
- V. **Physical Features:** The proposed quarry is bare field land with very little vegetation. There are no buildings to be erected and there is already an access to the site thru the adjacent quarry

**VI. Construction:**

- i. Road access to the quarry location does not require any upgrades
- ii. Grubbing of overburden
- iii. Pit development and sediment control

**VII. Clearing:** A grubbing material will be stock piled and used for reclamation.

**5. Operations:**

- I. A removal of sand and gravel through excavation
- II. Screening will be done off site at the companies address on Stanhope Road
- III. Sand, stone and gravel will be supplied to the neighbouring communities
- IV. Equipment in use will be tracked excavators, front end loaders and dump trucks
- V. Period of operation is from April to November
- VI. The grounds will be maintained according to environmental health and safety standards and regulations
- VII. A long term quarry development plan will be completed by AMEC environmental engineers who has already been commissioned to do so upon approval of this application
- VIII. No drilling or blasting will take place.

**6. Termination of Operation/ Reclamation:**

- I. Life expectancy of the pit is 50 + years
- II. Pit will be sloped and overburden will be replaced every fall to reclaim what is disturbed up to pit face
- III. At the end of pit life the entire mined area will be seeded to reproduce its natural landscape.

**7. Occupations:**

- I. This quarry will support the following employment in season:
  - i. 1 - Quarry Forman
  - ii. 3 – Heavy Equipment Operators

**8. Project related documents:** There are no project related documents.

**9. Approval of the Undertaking:**

- I. Environmental Protection Act – Assessment Regulations: Permit to Proceed
- II. Quarry Materials Act and Quarry Minerals Regulations: Quarry Permit
- III. Once this application is approved we will proceed as discussed with Mr. Fred Kirby of Department of Mines and Energy to amalgamate all permits associated A & B Construction and the Brown's Arm Pit and transfer into a lease agreement. All permit numbers are: 125505, 7115977, 7112272

**10. Funding:** The project is self funded by A & B Construction Ltd. – Kirk & Ann Marie Hodder



Date: July 30th, 2012

Signatures of Kirk & Ann Marie Hodder



Kirk Hodder



Ann Marie Hodder

Sketch of Undertaking (Hubert Porters Land)

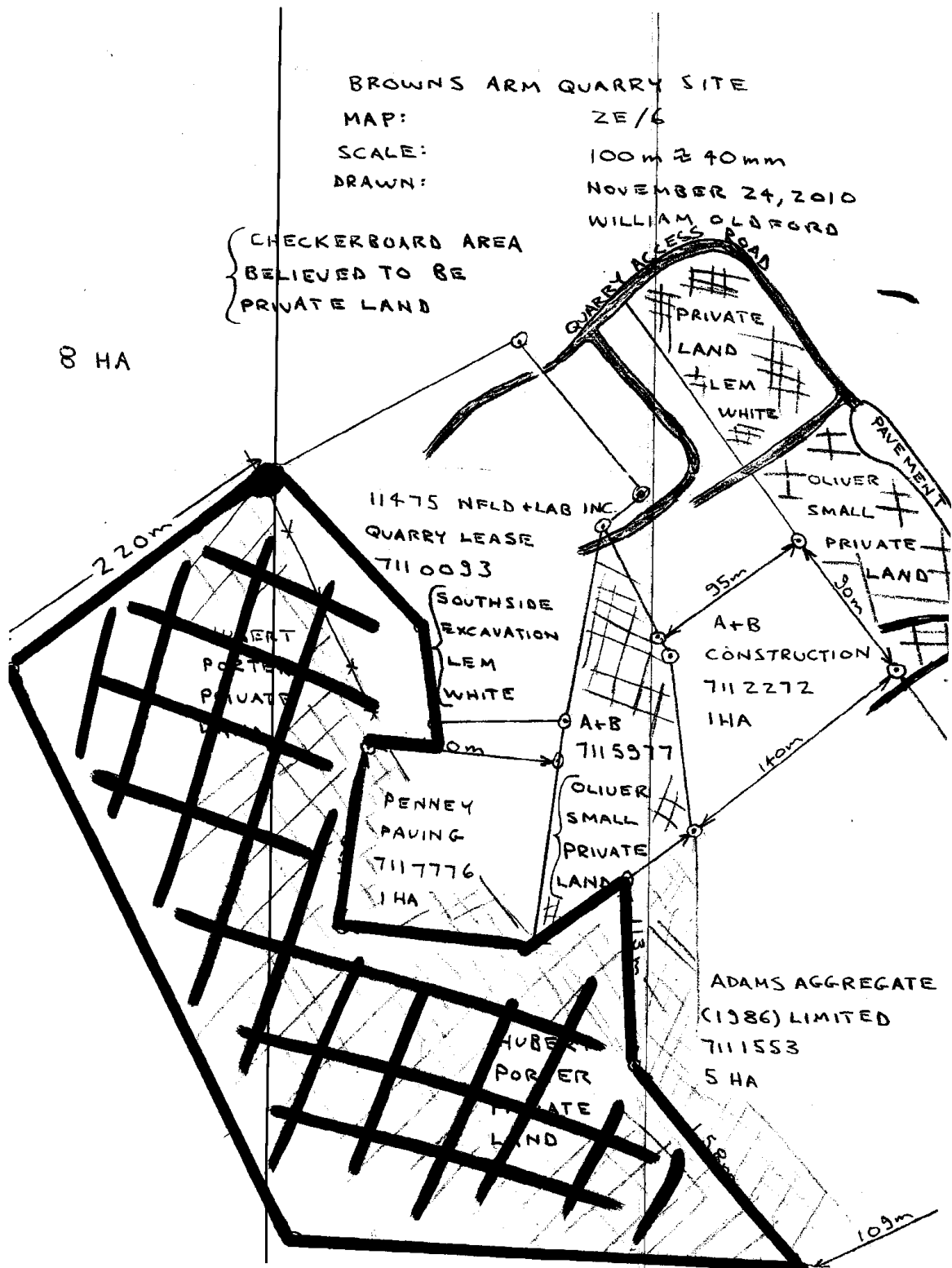



Map Showing Road from Lewisporte Junction Overpass (Trans Canada Hwy) to A&B Pit Access (Brown's Arm)

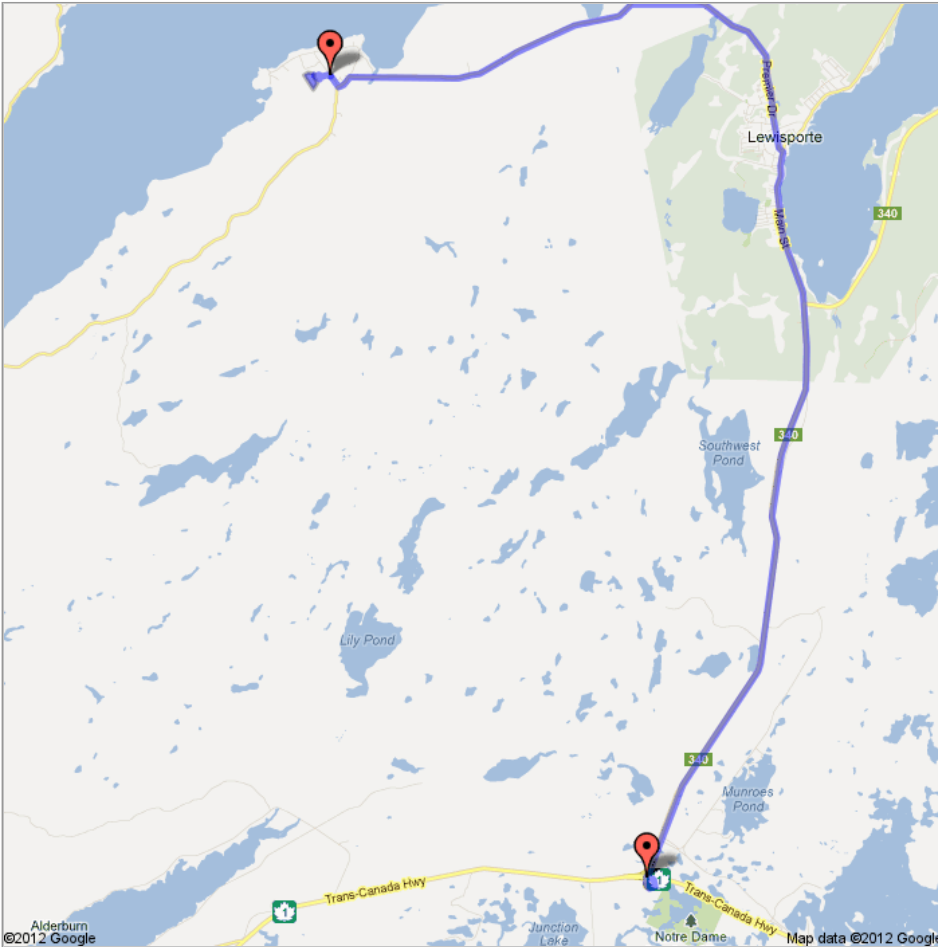

### A & B Browns Arm Pit

Newfoundland and Labrador 340 N

1. Head north on Newfoundland and Labrador 340 N

11.3 km

2. Continue onto Main St/Hwy 342 (signs for Newfoundland and Labrador 341/Embree)

2.9 km

3. Turn left onto Premier Dr/Hwy 341 (signs for Stanhope/Brown's Arm/NL-341/Trans-Canada Highway/Newfoundland and Labrador 1)  
Continue to follow Hwy 341

4.3 km

4. Turn left to stay on Hwy 341 (signs for NL-341/Brown's Arm/Laurenceton)

6.4 km

5. Turn left to stay on Hwy 341

290 m

6. Take the 3rd right onto Trail Avenue

Destination (A&B Pit Access) will be on the left

240 m

Unlisted · 5 views

Created on Jul 28 · By · Updated 10 minutes ago

Lewisporte Junction Overpass (Trans Canada Highway)

A&B Pit Access

Quarry Requested

Access Road to A&B Pit

Lewisporte Junction Overpass - A&B Pit



**A & B Brown's Arm Pit (Quarry Request)**