

# Town of Bay Roberts Land Use Zoning Map 2 and 2A

- [R1] Residential 1
- [R2] Residential 2
- [MD] Mixed Development
- [C] Commercial
- [IG] Industrial General
- [IM] Industrial Marine
- [IDA] Industrial Development Area
- [RU] Rural
- [HR] Highway Reserve
- [OSR] Open Space Recreation
- [EP] Environmental Protection
- [CDA] Comprehensive Development Area (Mad Rocks Heritage Area)

- Planning Area Boundary
- - - Municipal Boundary
- - - Municipal and Planning Area Boundary
- Blueberry Management Area
- Aggregate Resource

Dated at Bay Roberts, Newfoundland and Labrador

This 28<sup>th</sup> day of June, 2010-2011

Glen Littlejohn, Mayor

Shirley Hawe, Town Clerk

I certify that these Development Regulations for Bay Roberts has been prepared in accordance with the requirements of the *Urban and Rural Planning Act 2000*.

Development Regulations/Amendment  
**REGISTERED**  
Number: 265-2012-004  
Date: January 5, 2012  
Signature: *Mary Bishop*

Mary Bishop, FCIP

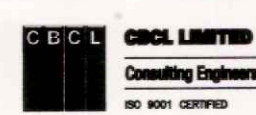

Mary D. Bishop, M.Eng., P.Eng.  
Senior Project Manager  
Environmental Services  
20 James Street West  
St. John's, NL A1B 1X6

Mapping services by: Geo-Matrix Services Ltd. (GIS, Inc.)

Map 2



Insert - Map 2A

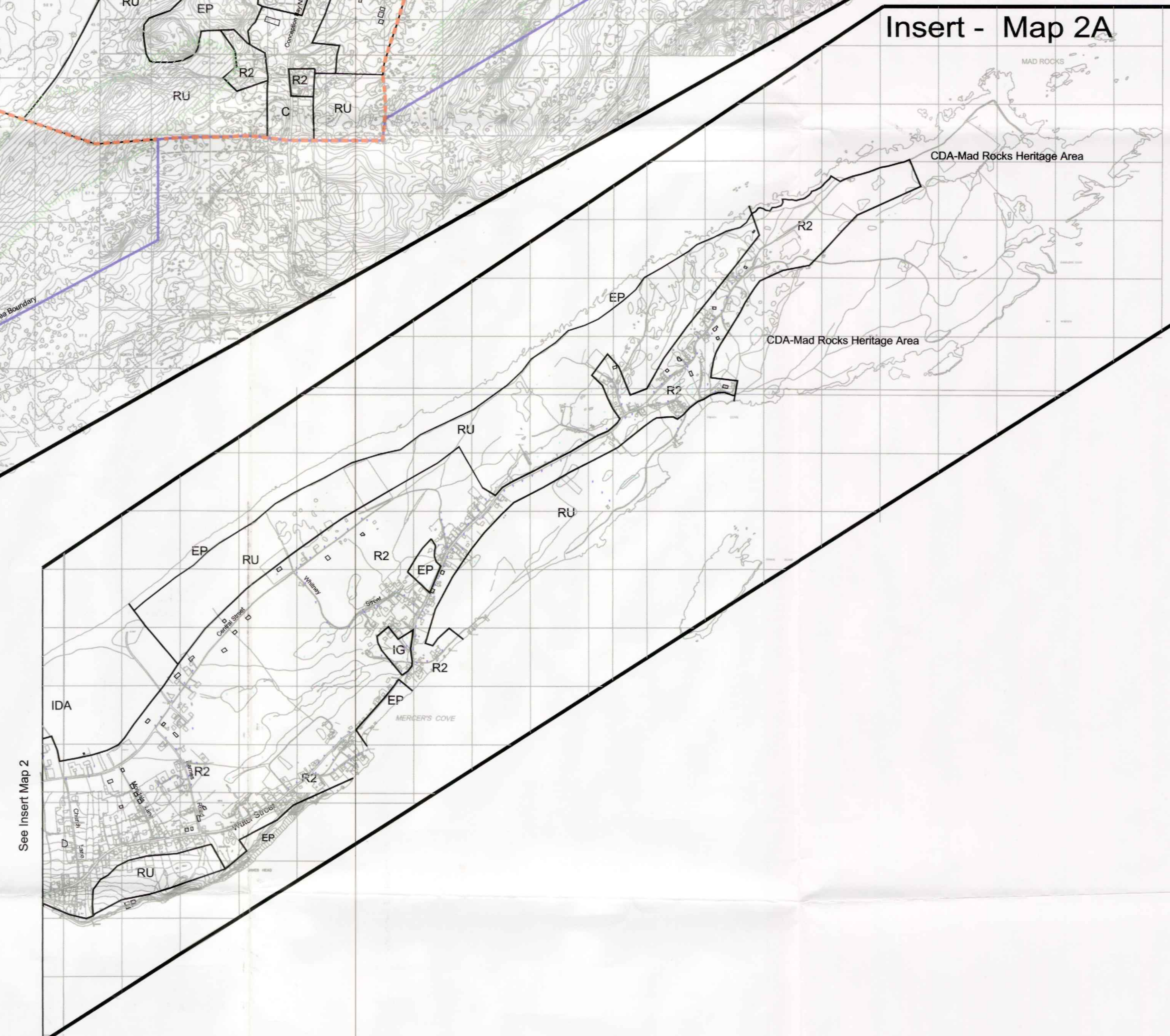

INDEX MAP

